



# LUG TYPE BUTTERFLY VALVE



## 技術參數 Specification

尺寸(SIZE)	DN50 ~ DN600
適用壓力(PRESSURE RATING)	PN10 / PN16, ANSI 150#, JIS 10K
閥體試驗壓力(BODY TEST PRESSURE)	1.5 ~ 2.4 Mpa
密封試驗壓力(SEAT TEST PRESSURE)	1.1 ~ 1.7Mpa
適用溫度(OPERATION TEMPERATURE)	-50°C ~ 200°C
適用流體(FLUID)	污水, 水, 油, 氣 Sewage, Water, Oil, Gas
表面塗裝(PAINTING)	環氧樹脂粉體塗裝 Epoxy Coating

## 特點 Feature

- ▶ 閥座採用可拆卸設計以便現場維修，並採用全通徑設計，不易受雜質影響，兩側的 O 型環使安裝時不須添加墊片而保持可靠的密封，並可根據不同的使用環境選用適合的材質。
- ▶ 閥瓣是採用更有效率的設計，可變向使用，流體阻力小，流量特性好。
- ▶ 軸銷採用美國專利設計退拔銷結構，將閥瓣閥軸緊密結合在一起。
- ▶ 閥體結構長度系列遵照 ISO5752 標準設計。
- ▶ 驅動器連接遵照 ISO5211 標準設計。
- ▶ 驅動裝置選用靈活，可因需求配置手動、電動、氣動等不同驅動裝置。
- ▶ The valve seat can be easily disassembles and assembled that will be easy to maintenances online. Full port design for the valves, the impurities cannot influence the open or close of the valve. The unit O-rings connect with the two ends of the valves insured the valves securely joint with the pipelines without any other gaskets. The seat can use different materials depend on the media and working condition.
- ▶ The structure of the disc is streamlined design. It can be used at bi-direction operate. The flow resistant is lower and flow character is well.
- ▶ Unique design for taper pin, which caused the disc and the shaft connect very well.
- ▶ The length of Face to Face acc to the standard of ISO5752.
- ▶ The standard acc to ISO 5211, Which connection between the valves and the actuators.
- ▶ The actuators can choose the Manual operator, Electric actuators, and Pneumatic actuators depend to the customer's requirements.

## 材質表 Materials

零件名稱	Name	規格	Specification	JIS	ASTM
閥體	Body	鑄鐵	Cast Iron	FC 200	A126 CI.B
		球墨鑄鐵	Ductile Iron	FCD400	A395
		不銹鋼	Stainless Steel	SCS 13A SCS 14A	A351 Gr. CF8 A351 Gr. CF8M
閥瓣	Disc	球鐵鍍鎳	D.I. + Nickel Plated		
		球墨鑄鐵	Ductile Iron	FCD400	A395
		不銹鋼	Stainless Steel	SCS 13A	A351 Gr. CF8
				SCS 14A	A351 Gr. CF8M
鋁青銅	Alu-Bronze	ALBC2	B148 C95400		
閥杆	Stem	不銹鋼	Stainless Steel	SUS 410	A182 Gr. F6A
				SUS 304	A182 Gr. F304
				SUS 316	A182 Gr. F316
閥座	Seat	晴橡膠	NBR	/	/
		乙烯橡膠	EPDM		
		四氯化碳橡膠	VITON		
		速立康	Slicon		
		聚四氟乙烯	PTFE		
軸銷	Taper pin	不銹鋼	Stainless Steel	SUS 304	A182 Gr. F304
O 型環	O-Ring	晴橡膠	NBR		



# LUG TYPE BUTTERFLY VALVE

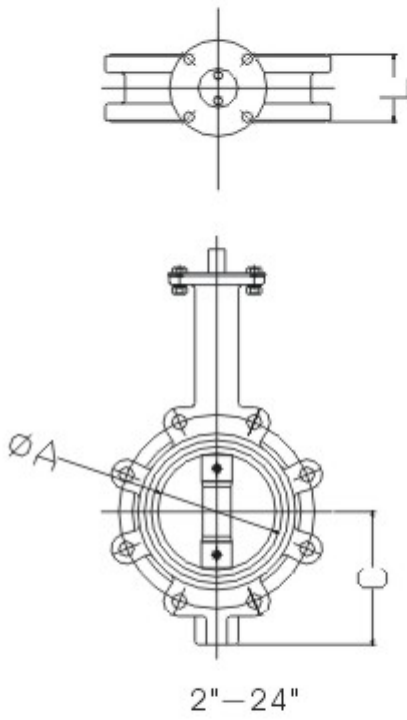

**Valve**

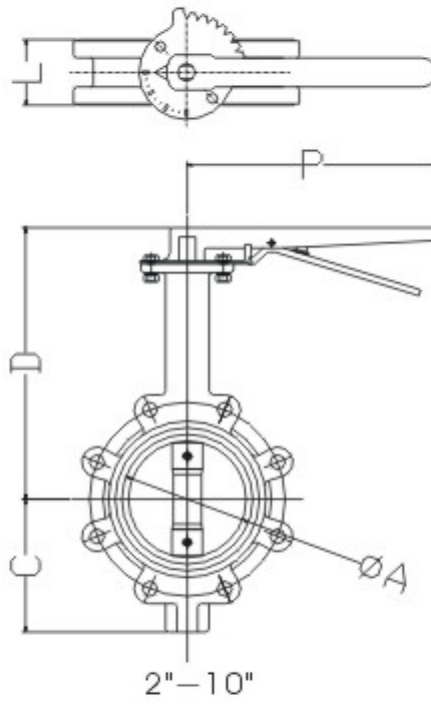

**Lever**

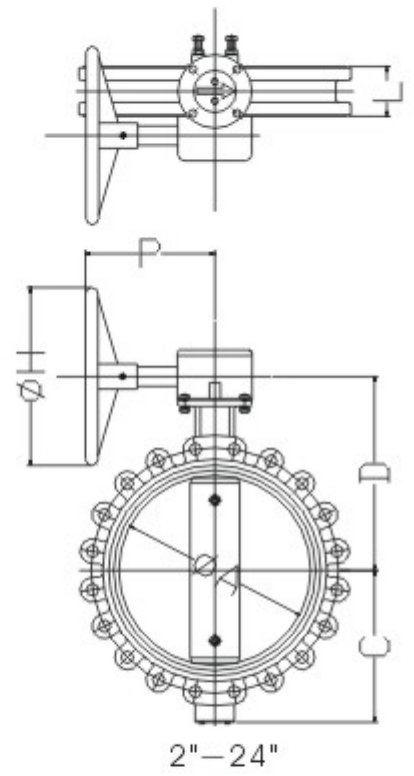

**Worm Gear**

## 尺寸表 Dimension

Size		Valve			Lever		Worm Gear		
INCH	MM	ØA	C	L	D	P	D	P	ØH
2	50	50	66	43	168	170	168	170	160
2.5	65	65	79	46	178	170	178	170	160
3	80	80	91	46	186	170	186	170	160
4	100	99	110	52	200	250	203	170	160
5	125	124	124	56	219	250	216	170	160
6	150	149	140	56	263	410	237	170	160
8	200	199	176	60	298	410	321	260	250
10	250	250	210	68	333	410	321	260	250
12	300	299	240	78	NA	NA	373	260	250
14	350	328	274	78	NA	NA	390	280	305
16	400	380	315	102	NA	NA	400	300	305
18	450	431	345	114	NA	NA	430	300	305
20	500	489	390	127	NA	NA	498	330	457
24	600	588	465	154	NA	NA	575	330	457